

Cape Escape – Guest Guide Book

Table of Contents

1	Welcome to Cape Escape	1
2	Living Area	3
2.1	TV and Stereo Instructions	4
2.2	Electric Fireplace Instructions	4
3	Kitchen	5
4	Bedrooms	6
4.1	Sea Grass Room	6
4.2	Coral Room	7
4.3	Sunset Room	8
4.4	Bunk Room	9
4.5	Game Room	10
5	Exterior	11
6	Golf Cart	13
6.1	Operation	13
6.2	Maintenance	14
	Appendix A – Cape Escape Golf Cart Agreement	15

1 Welcome to Cape Escape

Hello! Robert, Teresa, Grace, Taylor, and Hunter welcome you to our home. We pray that you will have a blessed and memorable stay. If you need assistance, Cobb is available during normal business hours 7 days a week at 409-684-3790 and after hours at 409-771-6331. For any major issues with the Golf Cart, you should call Jay McCurdy with Texas Custom Carts at 915-203-3330.

Below is a basic list of helpful tips to get you started. You will find more details in the following sections.

- There is a welcome basket from us – the owners- for your pleasure. In it you will find a post card of Cape Escape with contact information and websites for your convenience. Keep it and, if you want to come back for a future vacation, you'll have our contact info. Or pass it along to a friend.
- Internet password: **(shown on hard copy in the house)**
- All 6 TVs are powered by Direct TV and have DVR/DVD/Blu-ray capability. TV's are all "smart" capable (either direct or via Blu-ray or Xbox).
- Living room Audio and Visual equipment: **Please use the Universal Remote.** Make sure all items are "off"; then you can push "watch TV" or the "more Activities" button. There are 7 activities to choose from. Select the one you want and point the remote toward the items for a few seconds (activates them one at a time). Give the Satellite and Stereo receiver a few seconds to fully become operable.
- There is an Xbox 360 in the Game Room for your use. There are several games provided. Please keep these games separated from those you brought and place the controllers back on the charger after playing.
- Living room ceiling fan and light remote controller is mounted by the front door. This should not be removed from mounted position. Use the light switch to activate power and the remote to control the fan speed and turn the light on and off.
- Feel free to use and eat anything in the cabinets, fridge, etc.
- There are pillows and blankets for all 20 sleeping areas in the home. They are located on or near each bed. Bedding for the queen sleeper sofa in the living room is in the wicker basket coffee table, and the bedding for the Game Room futon and EZ-bed is in the closet.
- Please **DO NOT** put Cape Escape Quilts, Shams, Blankets, etc. into a pile on the floor with the sheets and towels to be picked up by Linen service. Please leave them on the beds.
- All bathrooms have timed exhaust fans to help dry the moisture as quick as possible. Please use each time you take a shower (during and after), and run for at least 20 minutes.
- **Our home is on a septic system so please do not flush anything but toilet paper, and liquids only down the drains. Also, only use liquid detergent in washing machine and dishwasher – no pods or powders please.**

- There is a locked storage room on the ground floor that contains a gas grill, charcoal grill, bar stools, chairs, beach toys, etc. Feel free to use any of these. **Your key to the house will open this door.** You may also want to store some of your personal beach gear here as well.
- Two hot showers and three hoses are available on the ground floor to rinse off and clean up before coming in to the home from the beach. Please help keep as much sand outside as possible.
- If you are renting the Golf Cart, **please rinse it off at least once a day, every day!** Please rinse everything including the undercarriage and engine compartment (flip up the backseat). SUPPER UNLEADED gas only please. You can fill up with the can or drive to the station at Stingaree. Please leave the tank or can full. Golf cart problems – please call Jay at 915-203-3330.
- We'd love it if you have a few minutes to sign our Guest Book and write a review on the Cobb site to let us know about your time at Cape Escape. You can also send suggestions to **info@capeescape.net**.

2 Living Area

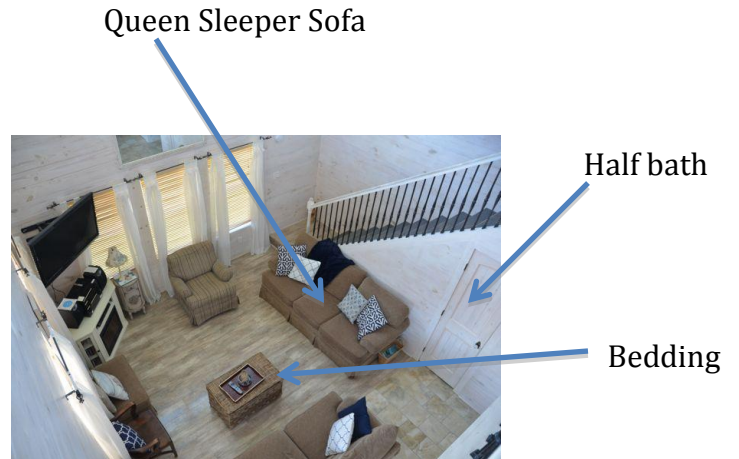

- TV, inside stereo, outside stereo, DirectTV receiver, Blu-ray, Netflix via Blu-ray
- Queen Sleeper sofa
 - Bedding is in wicker coffee table (lift lid/table top)
- Half bath located under stairs
- Light switch near the door powers fan and fan light
 - Use remote mounted on wall near the light switch to operate fan speed and light
- Light switch for main deck porch and carport located near the door
 - Two lights in the carport area automatically come on a night
- Light switches for the sconces are located at the bottom and top of the stairs
- Light switches for the upper deck porch are located near the door to the upper deck



2.1 TV and Stereo Instructions

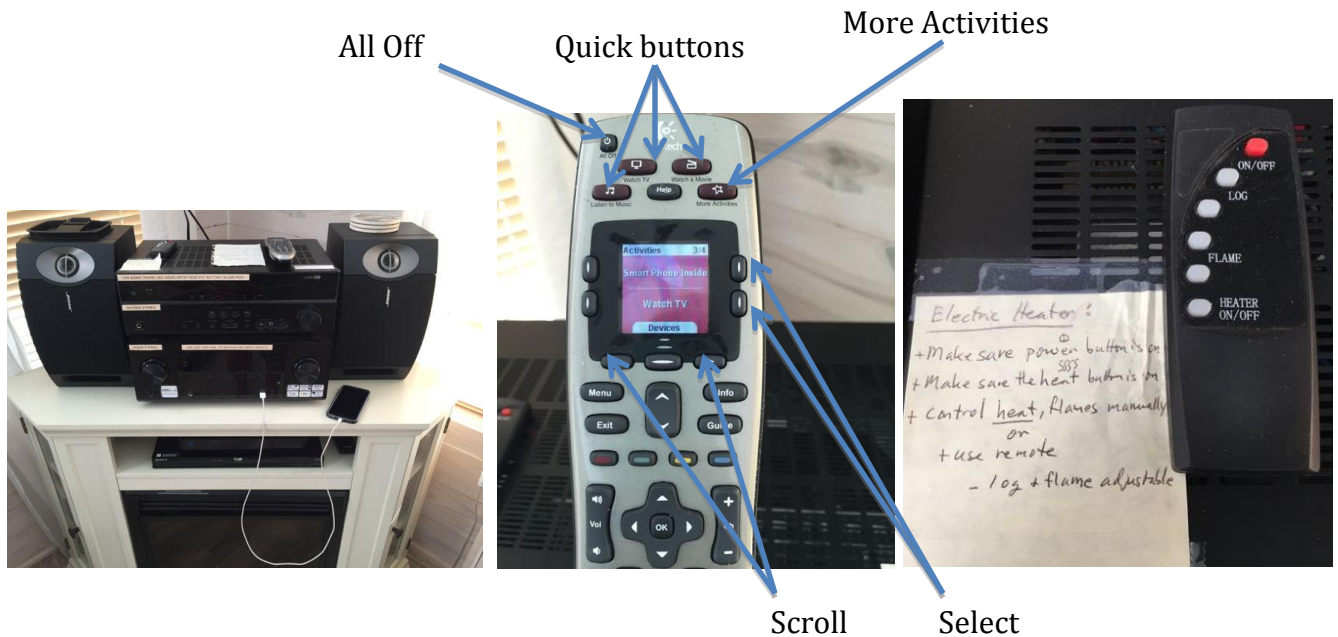

- Please use Universal remote for all TV/Stereo operations
 - Options: DirectTV, Blu-ray, Netflix and other Aps via Blu-ray, radio inside, iPhone inside, radio outside, iPhone outside
 - Inside/outside can be on at the same time but activate outside manually
 - Outside speakers on main deck and bar area downstairs
 - First, make sure all items are off
 - Use “All Off” button on Universal remote
 - If anything is still on, turn it off manually or with the applicable remote
 - Use quick buttons: “Watch TV”, “Watch a Movie”, “Listen to Music” or
 - Push “More Activities” button, scroll through the various options, and select the one you want
 - Point the remote in the general direction of all the electronics and hold it there for a few seconds
 - Remote activates each item one at a time
 - It takes a bit for the DirectTV receiver and the audio receiver to fully function

2.2 Electric Fireplace Instructions

- Manually turn on power
- Control heat and flame manually or with remote
 - Main power must be turned on manually for remote to function
 - Can independently adjust amount of flames and heat

3 Kitchen



Blender, Crockpot etc.



First aid



- Silverware in the drawer to the right of the sink
- One standard coffee pot and one Keurig with small and large K-cups and craft pot
- Crock pot, blender, porcelain griddle, electric shallow frying pan, and waffle maker are located above the refrigerator
- Pots and pans are located below the drawer below the silverware
- Misc. bowls etc. are in the cabinet below the kitchen island and in the corner cabinet to the left of the stove.
- Pot holders and misc. hand towels are in the drawer to the right of the refrigerator
- General cleaning supplies below the sink
- Minor first aid and bug spray supplies in cabinet above and to the right of the sink
- Laundry supplies and other brooms, mops, swiffer etc. just left of the refrigerator
- Washer and dryer in closet to the left of the refrigerator
 - Liquid detergents only for septic system
 - Please follow all instructions and cleanout the dryer lint trap regularly
- Please only use liquid detergents in dishwasher for septic system
 - No powders or pods in the dishwasher or washing machine

4 Bedrooms

4.1 Sea Grass Room



- Master Bedroom #1
- Queen bed
- Ceiling fan and light
- TV with DirectTV, Blu-ray, and Netflix and other Aps via Blu-ray
- Separate vanity and toilet
- Large shower with standard and rain shower heads shared with other Master Bedroom
 - Please use timed exhaust fan during and after showering for at least 20 minutes



4.2 Coral Room



- Master Bedroom #2
- Queen bed
- Ceiling fan and light
- TV with DirectTV, Blu-ray, and Netflix and other Aps via Blu-ray
- Separate vanity and toilet
- Large shower with standard and rain shower heads shared with other Master Bedroom
 - Please use timed exhaust fan during and after showering for at least 20 minutes



4.3 Sunset Room



- Queen bed and one twin bunk bed
- Ceiling fan and light
- TV with DirectTV, Blu-ray, and Netflix and other Aps via Smart TV
- Shared upstairs bathroom
- Please use timed exhaust fan during and after showering for at least 20 minutes



4.4 Bunk Room



- Two twin bunk beds and foldout chair twin bed
- Ceiling fan and light
- TV with DirectTV, Blu-ray, and Netflix and other Aps via Smart TV
- Shared upstairs bathroom
- Please use timed exhaust fan during and after showering for at least 20 minutes



4.5 Game Room



- One full futon, one twin bunk, and one twin EZ-bed
 - Bedding for futon and EZ-bed is in the closet
- Ceiling fan and light; plus recessed dimmable lights
- TV with DirectTV, DVD/Netflix and other Aps via Xbox 360
- Xbox 360 gaming system with multiple games and two Controllers
- Board games, cards, and poker for loads of fun
- Shared upstairs bathroom
- Please use timed exhaust fan during and after showering for at least 20 minutes



5 Exterior



Upper Deck

Main Deck

Swing and Dog House



Renter's lockable storage with gas and charcoal grills



Boys
Shower
around the
corner



Exterior
lockable gate

Electrical
power and
light switch

- Bar stools are kept in the storage room between renters
 - Please put stools back in storage prior to checkout

6 Golf Cart



6.1 Operation



- Follow all instructions in the **Cape Escape Golf Cart Agreement**
- Major issues call: Jay McCurdy with Texas Custom Carts at 915-203-3330
- Put cart in gear – forward, neutral, or reverse
- Key must be in “on” position to start (just push the gas peddle to start)
 - If motor does not start, pull the choke a few times and try again
- Always remove key when leaving cart unattended
 - If key is left in cart, leave key in the “off” position
- Make sure lights are off when not in use
- Only drive on the beach or in neighborhoods
 - It is illegal to drive down Hwy 87
 - Crossing is ok

6.2 Maintenance



- Please **rinse the cart off at least once every day** – VERY IMPORTANT
 - Rinse all parts of the cart including the engine compartment and undercarriage
 - Need to lift up the middle row seat to expose engine
 - Leave key in ignition while rinsing
 - Place the cart in the grass to the right of the house when rinsing
 - Keeps sand off the driveway
 - Two separate hoses are nearby for convenience
- Use only **Super Unleaded** fuel
 - Gas tank is in the engine compartment under the seats in the middle row
 - Fill at the Valero gas station on Hwy 87 at Stingaree or use the gas can provided
 - Go down the beach to Stingaree and then cross Hwy 87 to Valero
 - If you use the gas can, be sure to fill it on the ground to avoid issues with static electricity
 - Please leave the gas tank or can full of gas for the next renter



Appendix A – Cape Escape Golf Cart Agreement

CAPE ESCAPE GOLF CART BINDING GOLF CART AGREEMENT

(Please read carefully before signing and returning.)

In consideration for the rental of the golf cart provided by Owner of CAPE ESCAPE,

I, _____, agree to the following conditions. In the event that I violate any of the following conditions, I agree and understand that further use of the golf cart may be revoked immediately and without notice:

1. I promise to return the golf cart to CAPE ESCAPE immediately upon completion of the rental period in as good condition as I received the same. I will operate the golf cart safely and responsibly, and I will preserve and protect the golf cart from loss or damage to the cart itself, my person or property, and the persons or property of others. I agree and understand failure to comply with the terms of this agreement will result in a forfeiture of my rental fees and deposit. **I agree to be legally and financially liable for all costs of repairs to the golf cart and for the loss, damage and/or injuries to my person or property and the persons or property of others regardless of fault.** I agree to reimburse the golf cart owner for such unrecovered costs, including but not limited to deductibles and any uninsured losses.

2. I agree to hold harmless, defend and indemnify Cape Escape and Cobb Real Estate, Inc., for any and all damages and claims of any nature whatsoever that may arise from the use of said golf cart during the time of the rental period, including but not limited to claims for damages to the golf cart itself, my person and property and the persons and property of others.

3. I agree to become familiar with the operation and use of said golf cart, to read the "GOLF CART INFORMATION SHEET" and any other instructions provided to me regarding the cart, and to operate the golf cart in accordance with said instructions. I Agree to contact COBB REAL ESTATE or Jay (915) 203-3330 if I have any questions or concerns about operating the golf cart or if my guest or I have caused any damage to the golf cart or others through the use of the golf cart. I agree to examine and inspect the safety and mechanical condition of the golf cart, reporting any concerns or problems before driving the vehicle.

4. I understand that a golf cart is subject to the same laws and regulations pertaining to motor vehicles and therefore agree that the golf cart will be operated in accordance with the laws of the State of Texas and the local laws of Galveston County, including but not limited to the requirement that persons driving the golf cart must not be under the influence of alcohol and/or illegal drugs. I further agree that I personally will be responsible for all moving and/or parking violations issued to said cart while it is in my possession, under my control, or at any time during rental period. I agree that I will not operate the golf cart at night or in the surf or allow salt water to come in contact of mechanical or electrical components. I further agree that law prohibits me from using the golf cart on or along Hwy 87.

5. I agree that only persons who are **21 years or older**, possess a valid driver's license and insurance as required by law shall be permitted to drive the golf cart. I further agree that the maximum occupancy of the golf cart is 6 persons, including children.

6. I agree the privilege of using the golf cart can be revoked without notice by CAPE ESCAPE / COBB REALESTATE, in their sole discretion, for any violation of this agreement. **I further agree I shall not be entitled any rental refund or deposit for such revocation of privilege.**

7. I understand that if the golf cart should become inoperable through no fault of mine, Owner will take reasonable steps to have the vehicle repaired. In the event the golf cart can not be repaired or replaced, a refund will be issued towards the unused rental agreement period.

By my signature below, I certify that I understand and agree to the conditions set forth in the **CAPE ESCAPE GOLF CART Binding Golf Cart Agreement**. I acknowledge that I have signed this document voluntarily and freely and that my signature creates a contractual obligation that binds me, my guests and all passengers.

Operator's Signature X _____

DATE: _____

Print Name _____

DL# _____ State _____.

Golf Cart Information Sheet

- Key must be removed from cart anytime it is left unattended. Turn the key in the "off" position when parked.
- DO NOT OPERATE Cart In The Surf or at Night. Do not drive the cart on other people's property, native grasses or on the dunes. Doing so will result in the loss of the use of the cart and your security deposit at a minimum, no exceptions!
- At no time should there be more than 6 passengers on the cart. Allowing more than 6 passengers on the cart will result in suspension damage and repair cost will be charged against your deposit.
- Do not make turns at high speeds. Slow down to turn or make corners especially with carts that have altered suspensions, as they are prone to rollover at high speeds.
- It is our goal to provide customers with reliable golf carts by which we perform routine maintenance. Do not for any reason attempt to perform maintenance or repairs on the cart. If you are unable to resolve the problem, contact Cobb Real Estate immediately and we will send out a mechanic as soon as possible. Should the problem result in the loss of use during the agreed upon rental time, you will be refunded appropriately. Failure to notify us of a problem will result in no refund for that period of time we were not notified of the problem. In the event we are requested to make a service call and it is determined that the problem is the result of improper operation of the cart or failure to follow the proper procedures described in the golf cart agreement, a \$25.00 fee will be charged against your deposit.
- When filling the gas cart, only clean fresh **Super Unleaded Gas must be used**. No regular gas please! Regular gas will clog the fuel filter. Leave approximately 5 gallons of gas in the cart and/or the Gas Can provided. The cart may be fueled at Valero at the intersection of Hwy 87 and Stingaree. The cart can be driven down the beach 1 mile to Stingaree to get to the gas station. It is ok to cross Hwy 87. You may also fill the Gas Can and add to the cart. There is no gas gage, so it is necessary to check the fuel level by lifting the middle seat. One tank goes a long way, but it is wise to check it before every use.
- At least once every day and upon completion of rental, cart should be washed off thoroughly. Do not use a pressure washer, water hose with a sprayer will be sufficient. Make sure that the entire cart is rinsed, including the undercarriage. Please park the cart on the grass while rinsing to keep sand off the driveway. Properly rinsing the cart is critical to extending the life and maintaining its condition. **"Note" Failure to wash the cart daily and at the completion of rental period will result in a \$25.00 cleaning fee that will be charged against your deposit.**
- Our carts are inspected for damage at the beginning and end of rental period. In the event the cart is damaged during the rental period an estimated repair cost will be charged against your deposit.
- Contact Number for service is: JAY (915) 203-3330

Operator's Signature X _____

DATE: _____